

USER AND MAINTENANCE MANUAL



SUBSOILER DR-60

THE MAIN PURPOSE OF THIS MANUAL IS TO PROVIDE THE CUSTOMER AND THE PERSONNEL IN CHARGE OF INTERACTING WITH THE MACHINE INSTRUCTIONS OF HOW TO OPERATE THE MACHINE IN ACCORDANCE WITH THE INSTRUCTIONS GIVEN HEREIN, FOR THE SAFEGUARD AND PROTECTION OF THE PERSONNEL THEMSELVES.

HOW TO READ AND USE THE "INSTRUCTION MANUAL"

This document is an integral part of the machine and thus of the initial delivery.

Therefore, it must be guarded and properly used throughout the operating life of the machine, even if it is transferred to a third party.

Any requests for additional copies of this document should be required by an order forwarded to the manufacturer.

It is mandatory to read the operating instructions CAREFULLY.

N.B. This instruction manual MUST always be within reach of the operator for reference at any time. Operators called upon to interact with the machine have a duty to properly document themselves using this manual before carrying out any work, adopting the specific prescriptions to make all types of human-tool interaction safe.

LIMITS OF USE.

DR-60 subsoilers are designed and manufactured for tilling. Therefore, EVERY OTHER TYPE OF EMPLOYMENT AND USE is ABSOLUTELY FORBIDDEN, in order to ensure, at all times, overall efficiency and safety.

DR-60 subsoilers are designed and manufactured exclusively for tillage, so lifting or carrying people and/or animals is strictly prohibited.

DR-60 subsoilers are equipped with 3-point hitch cat. 1-2. Maximum tractor power 70hp.

The article consists of a central body to which a reversible and replaceable knife is mounted. It is forbidden to mount knives that are not original Deleks and of a different shape, as the mechanical stability and efficiency of its parts could be affected.

Adjustments: The knife is mounted to the main body by 2 bolts. The knife can be raised or lowered according to the degree of consumption of the knife. It can also be turned 180°.

The use of the subsoiler by untrained and professionally trained personnel is strictly prohibited.

DELEKS Ltd.

Via Industriale, 23 - 25028 - Verolanuova (BS) - ITALY

Tel: +39-030-6585725 - E-mail: info@deleks.com

www.deleks.com

GENERAL INFORMATION

TOOL IDENTIFICATION DATA

The identification of the company, as the manufacturer of the implement, is carried out in accordance with the legislation in force by means of the acts listed below:

- DECLARATION OF CONFORMITY
- CE MARKINGS
- INSTRUCTION MANUAL

A special adhesive plaque, affixed to the machine indelibly carries the information listed below:

- MANUFACTURER'S BUSINESS NAME, ADDRESS
- CE MARKING
- MODEL
- YEAR OF MANUFACTURE

The sticker plate is attached to the machine in a visible place.

The relevant DECLARATION OF CONFORMITY is attached to the delivery of the tool.

It is forbidden to remove the CE MARK plate and/or exchange it with other plates of similar implements. If the CE MARKING plate is damaged or detached from the tool due to accidental reasons, the customer must compulsorily inform the manufacturer.

DANGER STICKERS

The tool is equipped with pictograms (labels) warning of residual hazards on the tool.



1. Keep a safe distance from the tool, foot shearing hazard (50m).
2. Never climb on top of the tool.
3. Keep a safe distance from the tool, danger of being hit by the tool.
4. Turn off the machine before performing repairs or maintenance and consult the manual.

The maximum overall dimensions of the tool are shown in the figure below:

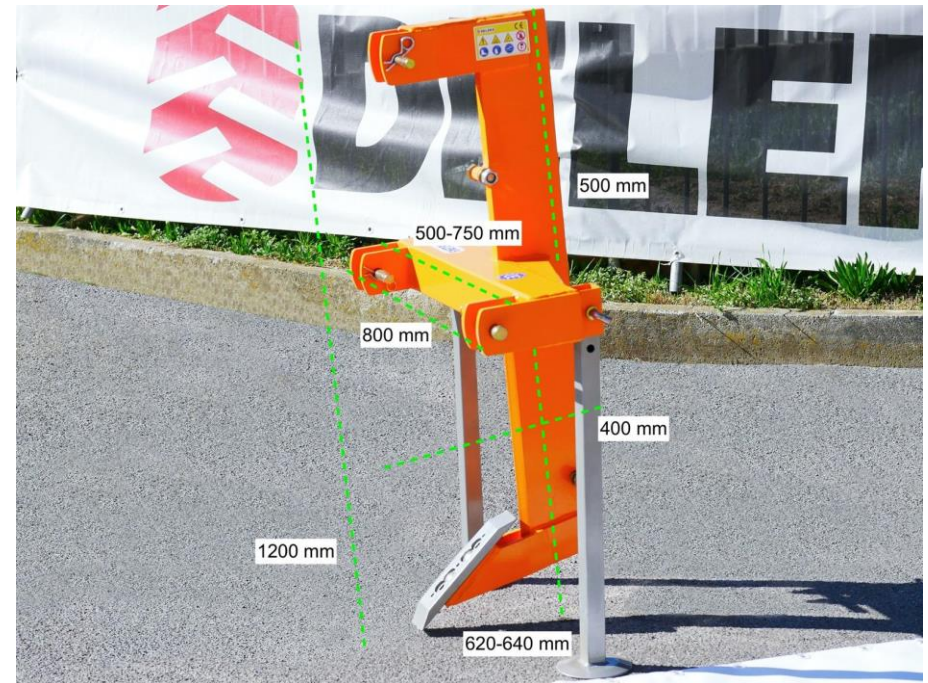

GENERAL INFORMATION

UPON RECEIPT OF THE GOODS CHECK THAT:

- The delivery corresponds to the order specifications.
- There is no damage due to transportation or otherwise. In case of damage or missing parts, inform the shipper or the Manufacturer immediately and in detail.

WARNING

All data and dimensions are not binding, and the Company reserves the right to change them without prior notice, guaranteeing to bring them to the user's attention later with updated data sheets.

TOOL TRANSPORTATION

In order to carry the tool, it is essential to follow the slinging directions as shown in the figure below:



IMPORTANT

Ropes appropriate for the weight should be used to lift the tool. The integrity of the ropes should be checked regularly. Never use ropes that have damage or injury, but replace them with intact ones. Avoid tugging on ropes caught under the load, and in the case of loads that have sharp edges or sharp edges, protect the ropes with edge protectors.

GENERAL WARNINGS

FOLLOW THE FOLLOWING PRECAUTIONS BEFORE OPERATING THE TOOL TO OPERATE IT SAFELY.

There should be no untrained persons near the tool when it is in operation.

For any adjustment or maintenance work, disconnect the implement from the tractor. When replacing parts, always request genuine spare parts from the manufacturer or its authorized dealer or retailer.

ATTACHMENT TO THE TRACTOR

When attaching to the tractor, the implement should only be placed on flat ground.

MAINTENANCE

A Check the attachment pins to the tractor every 2 hours of work.

B Check periodically before each work operation that the chisel is in good condition. In case of wear and tear, replace parts.

C Check the tightenings periodically.

D Check the coupling U-bolts, that they are always tight and not deformed. If so, they need to be replaced.

REQUEST FOR SPARE PARTS

Directions for ordering parts

In order to facilitate us to meet the needs of ordering spare parts without errors and in the shortest possible time, we strongly recommend that orders be placed according to the standards below.

Orders for spare parts must contain all elements necessary for the prompt and exact identification of the part, namely:

TYPE OF TOOL

QUANTITY REQUIRED FOR EACH PIECE

CODE NUMBER

DESCRIPTION

DATE OF DELIVERY OF THE TOOL

SPARES

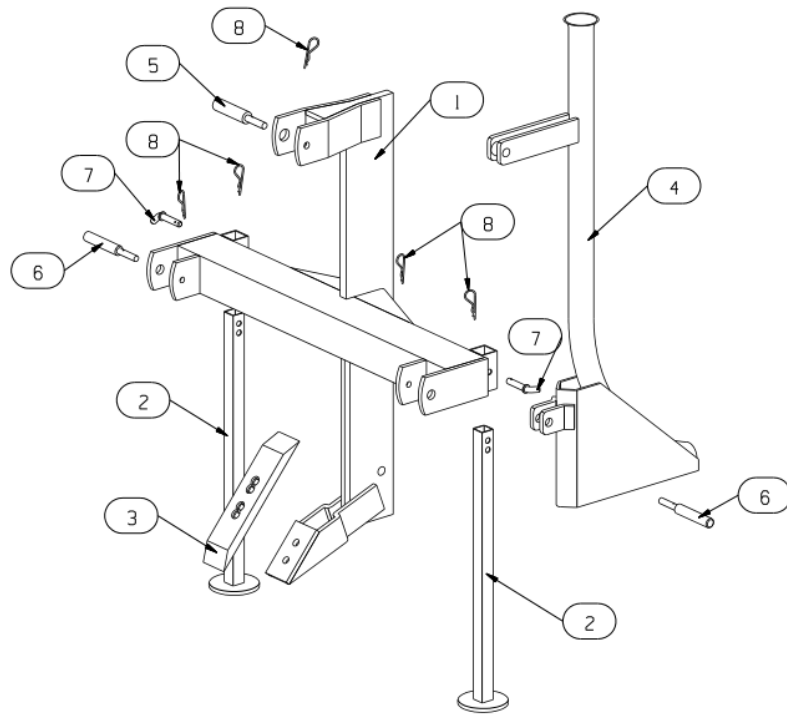

DELEKS Ltd.
 Via Industriale, 23 - 25028 - Verolanuova (BS) - ITALY
 Tel: +39-030-6585725 - E-mail: info@deleks.com
www.deleks.com

No.	Name	Qty
1	Ripper	1
2	Leg	2
3	Blade	1
4	Pipe Tube	1
5	Top Pins	1
6	Bottom Pins	2
7	Leg Pins	2
8	R pins	5